

## Notes

1. All Dims in mm Unless Otherwise Stated
2. Do Not Scale From This Drawing
3. Isolate All Dissimilar Materials With Barrier Tape
4. If in Doubt, ASK

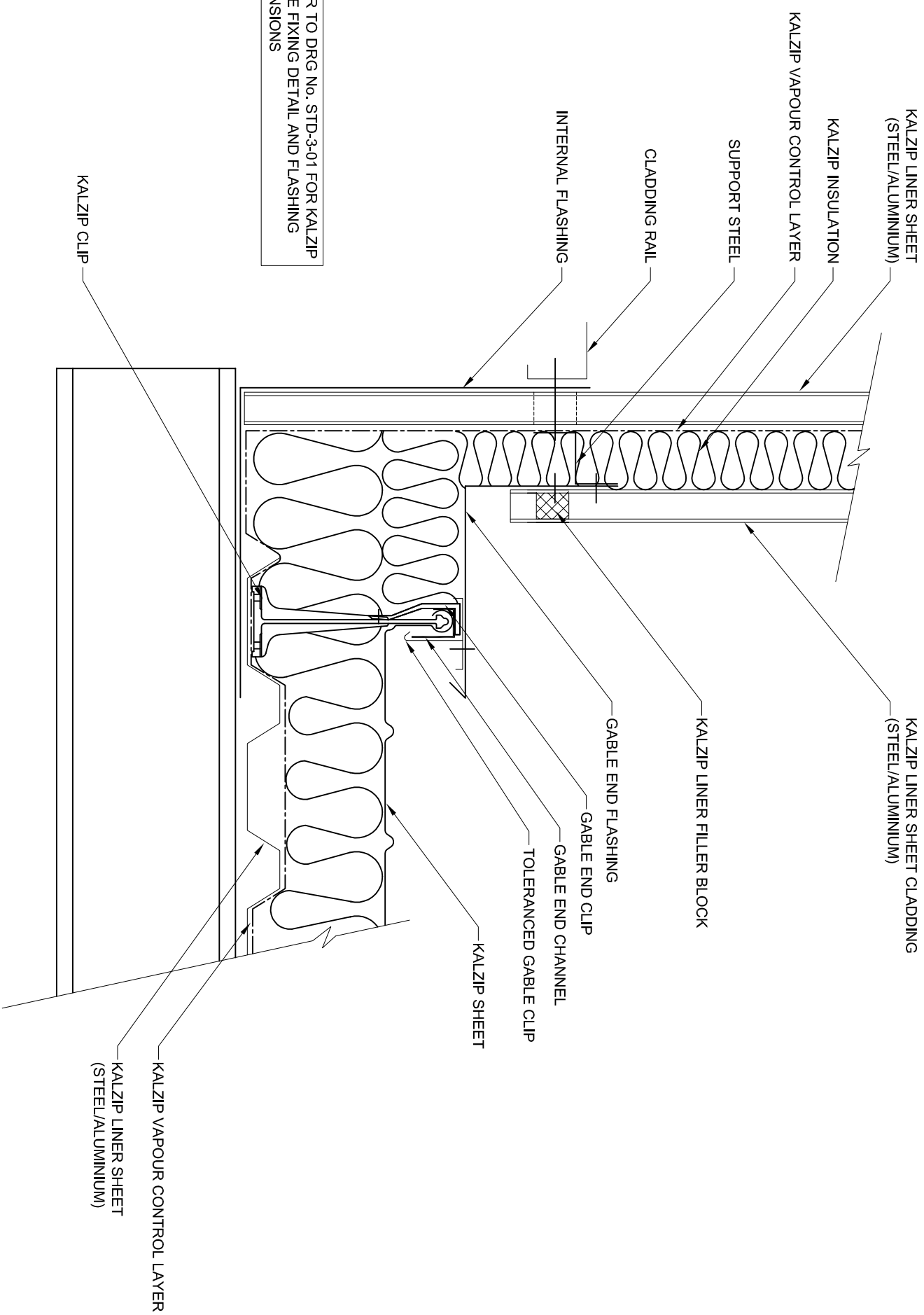

REFER TO DRG No. STD-3-01 FOR KALZIP  
GABLE FIXING DETAIL AND FLASHING  
DIMENSIONS

This drawing is copyright and is issued on the express condition that it is not to be copied or disclosed by or to any unauthorised person or firms without prior consent in writing from Kalzip.



## A Tata Steel Enterprise

Kalzip Ltd

Haydock Lane, Haydock, St. Helens

MERSEYSIDE, WA11 9TY

Tel: 01942 295 500

Fax: 01942 295 508

Project:

## Double Skin Constructions

Client:

Kalzip Ltd.

Title:
--------

### Double Skin Abutment Verge to Cladding

Scale:

1:5

1:5

Checked:

Dwg No.

Dwg No.

Rev: